

## Hyatt Regency Scottsdale Resort and Spa At Gainey Ranch

### DIRECTIONS

From Phoenix Sky Harbor Int'l Airport: Exit the airport following the signs to 202 East. Take the 202 East to 101 North. Continue on 101 North to the Via De Ventura Exit and make a left. Travel West for approximately 2 1/2 miles (Via De Ventura turns into Doubletree Ranch Road). The Hyatt Regency Scottsdale Resort and Spa will be on the right hand side just before Scottsdale Road.

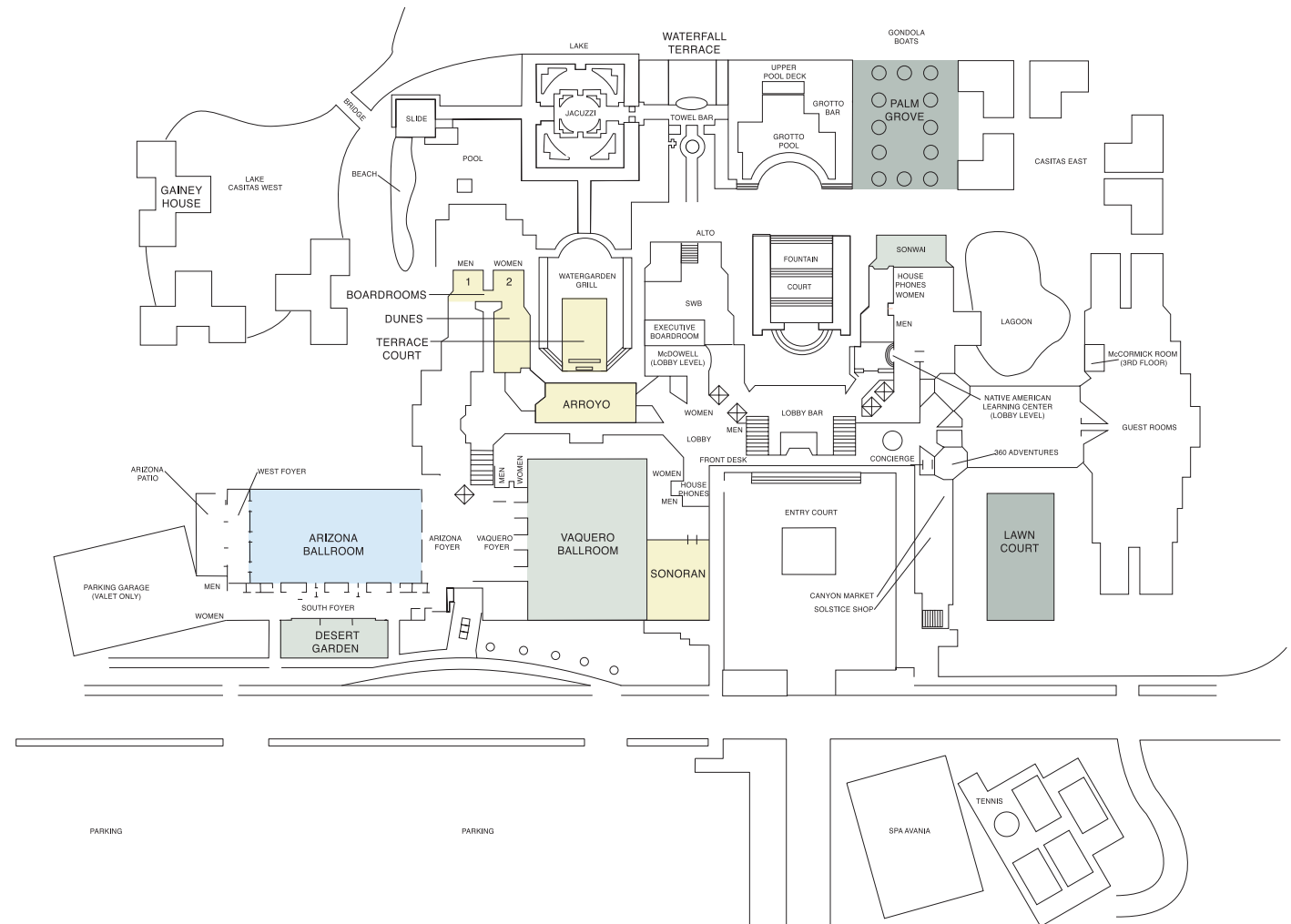

# Hyatt Regency Scottsdale Resort and Spa At Gainey Ranch

## FIRST FLOOR

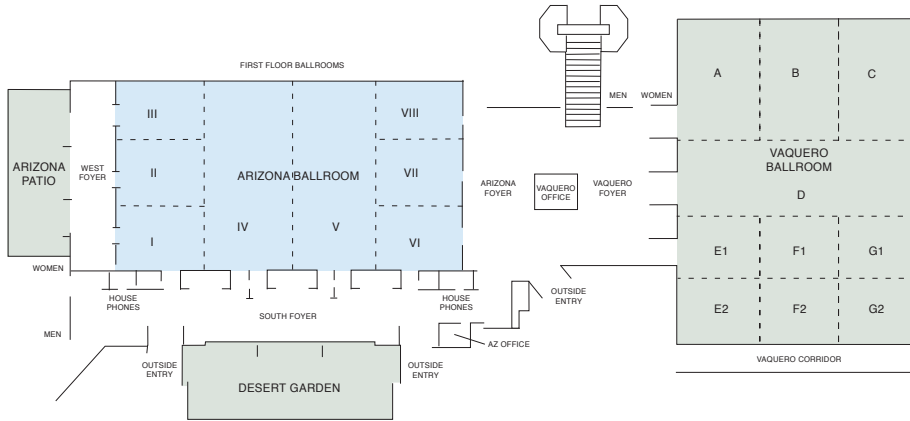

## SONWAI STUDIOS

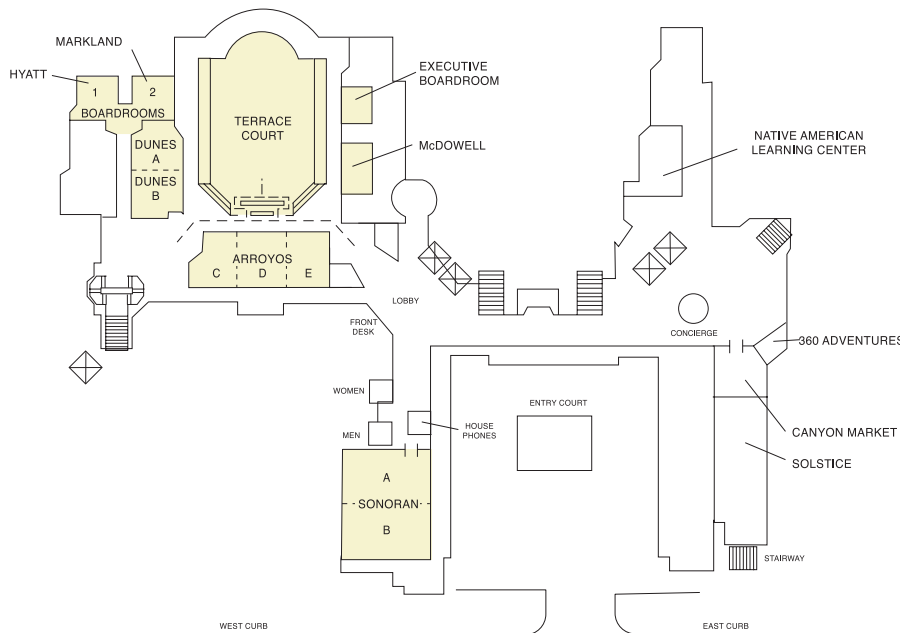
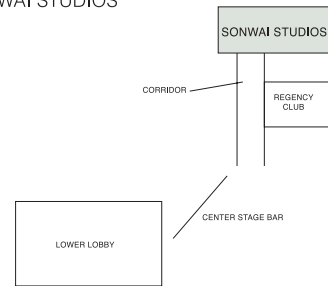

## SECOND FLOOR / ENTRY LEVEL